

wilson
&bradley

ARMSTRONG SMART LOCKS



CONTENTS



4. Overview



6. Digital Lock with Touch Panel



7. Super Sensor Lock



8. Flat Face Cabinet Lock

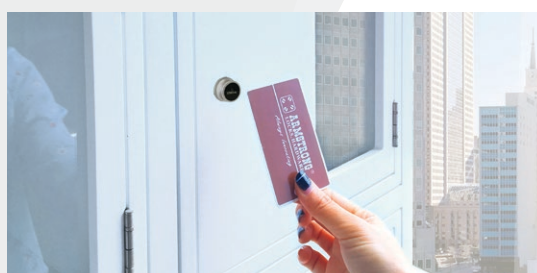

9. Knob Pull Cabinet Lock

ARMSTRONG SMART DIGITAL LOCKS

WILSON & BRADLEY

In this brochure you will find the latest range of Smart Digital Locks by Armstrong, available at Wilson & Bradley.

Easy to install and program, the Armstrong range allows for secure electronic locking of cabinets and are ideal for a range of places such as gyms, offices, schools and hospitals.



wilson
&bradley



ARMSTRONG SMART DIGITAL LOCKS

The Armstrong range of smart digital locks are ideal for use in a variety of places including; schools, gyms, hospitals and clubs.

They allow for the secure electronic locking of cabinets and lockers, using:

Pre-programmed management cards supplied with the lock, or alternatively and more flexible, any card featuring an RFID chip e.g. Credit card, Myki/Public Transport card.

Available in 5 styles, these locks work with AAA alkaline batteries and feature zinc alloy housing for added security.

Features

- Easy to program
- Automatic on-lock function
- Simple and easy to install
- No physical key required

Applications

Hospital, Office, School, Club, Bank, Gym etc. (Cupboards, cabinets, storage lockers, equipment, filing cabinets, jewellery cabinet).

Visit our website to find out more about the Armstrong range:

www.wilbrad.com.au

or call us on: **1800 633 507.**





SMART DIGITAL LOCK WITH TOUCH PANEL



Features

- Touch screen keypad – no need for key or card
- Simple to install – no need for software or PC
- Battery alarm - alerts you when battery life is about to run out
- Manual or auto locking options – use card to lock manually
- Auto lock function – will lock within 6 seconds of closing
- Management code provided – extra security if code is misplaced or forgotten
- Suitable for wood cabinets 19-35mm
- Material: Zinc alloy front case and ABS housing
- Finish:
 - Front case: Matte chrome -
 - Housing: Black
- Power Supply: 3 standard AAA alkaline batteries (not included)
- Includes: 1 x striking plate, 1 x set of installation screws

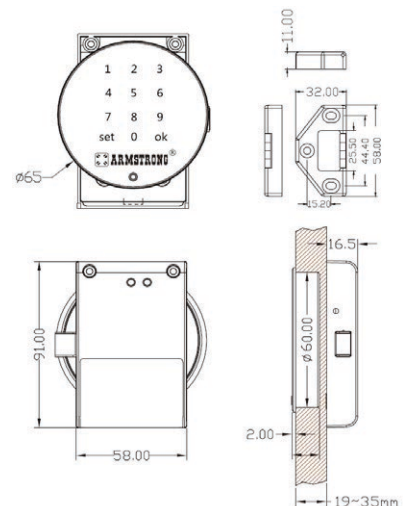

Code: **SDLTP65**



SMART DIGITAL SUPER SENSOR LOCK

Features

- Battery alarm - alerts you when battery life is about to run out
- Manual or auto locking options - use card to lock manually
- Auto lock function - will lock within 6 seconds of closing
- Suitable for wood cabinets 16-30mm
- Material: ABS housing
- Power Supply: 3 standard AAA alkaline batteries (not included)
- Includes: 1 x striking plate, 1 x set of installation screws, 3 x user cards
- Invisible lock - lock hidden from view
- Card management system - touch card to open
- Simple to install - no need for software or PC

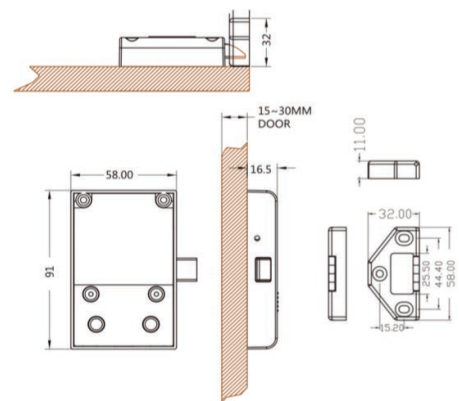

Code: **SDSSL30**



SMART DIGITAL FLAT FACE CABINET LOCK



CABINET LOCK WITH FELICA HIGH FREQUENCY SYSTEM*

Features

- Suitable for wooden board 16-30mm
- Material: zinc alloy housing
- Power Supply: 3 standard AAA alkaline batteries (not included)
- Includes: 1 x striking plate, 1 x set of installation screws, 3 x management/user cards
- Electronic lock – Enhances the security level
- Card management system – touch card on knob to open
- Simple to install – no need for software or PC
- Battery alarm - alerts you when battery life is about to run out
- Manual or auto locking options – use card to lock manually
- Auto lock function – will lock within 6 seconds of closing

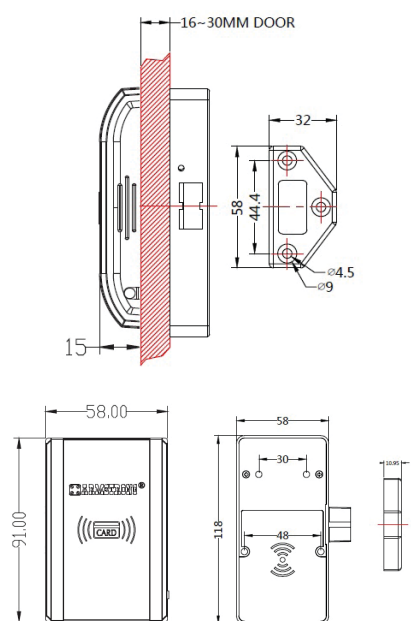

*The Felica system is a contactless RFID smart card system. This is a battery powered high frequency system.

Code: **SDCL201F**



SMART DIGITAL KNOB PULL CABINET LOCK

WITH FELICA HIGH FREQUENCY SYSTEM*

Features

- Reinforced electronic lock – Enhances the security level
- Card management system – touch card on knob to open
- Simple to install – no need for software or PC
- Battery alarm – alerts you when battery life is about to run out
- Manual or auto locking options – use card to lock manually
- Auto lock function – will lock within 6 seconds of closing
- Suitable for wood cabinets 16-30mm
- Material: ABS sensor knob and zinc alloy housing
- Power Supply: 3 standard AAA alkaline batteries (not included)
- Includes: 1 x striking plate, 1 x set of installation screws, 1 x steel fixing plate, 3 x management/user cards

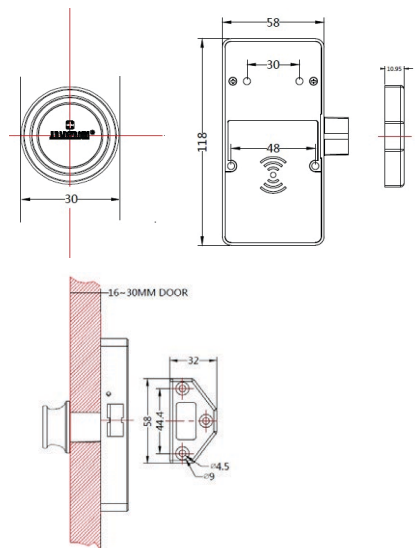

*The Felica system is a contactless RFID smart card system. This is a battery powered high frequency system.

Code: **SDCL207F**



Contact us for more information on any of our products, or visit our website for instructional videos, promotions and manuals.

Online Store

www.wilbrad.com.au

Phone

1800 633 507

VIC

94 Bell Street
Preston VIC 3072

NSW

Unit 4, 3 Basalt Road
Greystanes NSW 2145

WA

19 Christable Way
Landsdale WA 6065

QLD

105 Corymbia Place
Parkinson QLD 4115

SA

79 Frederick St
Welland SA 5007

TAS

Ph: 1800 633 507



Scan the QR code to view our interactive brochures online.



@wilsonandbradley