



AVENTOS

Mitred and rebated applications

AVENTOS – Mitred and rebated applications



Mitred application – AVENTOS HF bi-fold lift system



Rebated application – AVENTOS HF bi-fold lift system



Mitred application – AVENTOS HS up & over lift system



Rebated application – AVENTOS HS up & over lift system



Mitred application – AVENTOS HL lift up



Rebated application – AVENTOS HL lift up



Mitred application – AVENTOS HK stay lift system



Rebated application – AVENTOS HK stay lift system

An inspiring range of lift systems in motion

The mesmerising motion quality of the AVENTOS fittings is now also available for lift systems designed with mitres or rebates. The standard fittings can still be used with minor positional adjustment. Using the new application options, creative design ideas can be implemented to best effect.

Lift systems are particularly convenient as the smooth action and access to the cabinet are always achieved. AVENTOS lift systems also remain in any position when they are being opened and are therefore within easy reach to close. Extra convenience is provided by the SERVO-DRIVE or TIP-ON opening support systems

Contents

- 4 AVENTOS HF
- 8 AVENTOS HS
- 12 AVENTOS HL
- 16 AVENTOS HK
- 20 Motion technologies

AVENTOS HF – Mitred and rebated applications

Ordering information Symmetrical wooden fronts

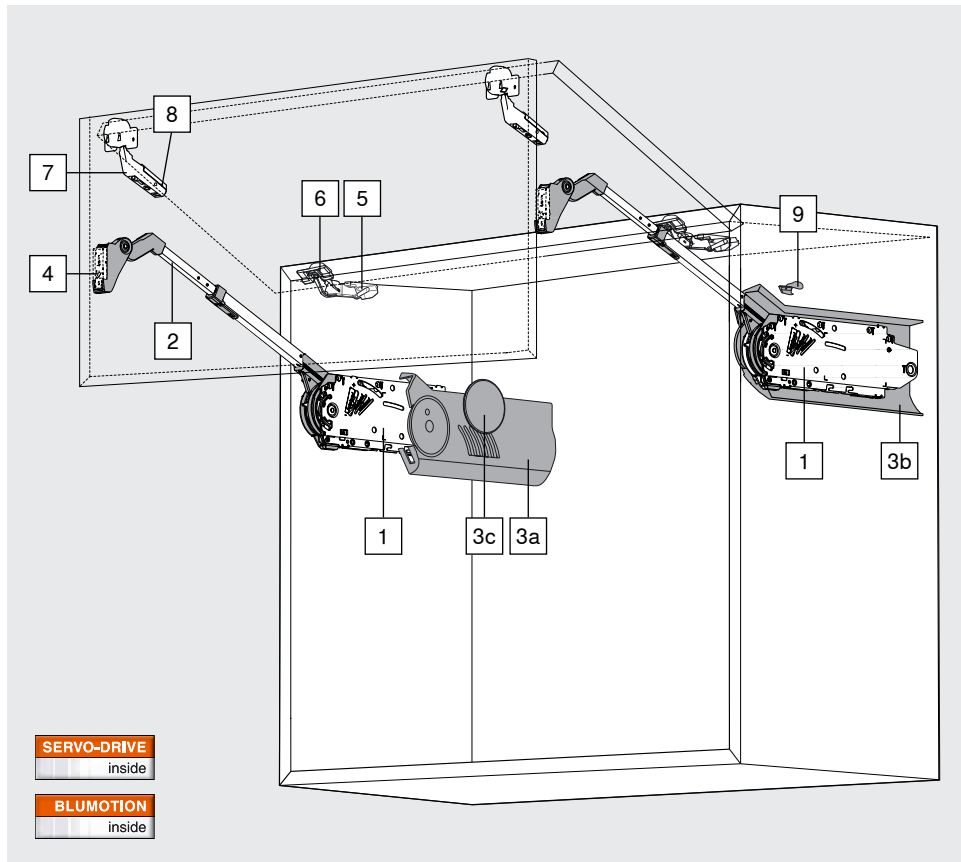

The AVENTOS HF bi-fold lift system is the ideal solution for high and mid height wall units. Thanks to the two-piece front, the overhead space requirement is reduced even for tall cabinets.

Unlike standard applications, for mitres or rebates you need:

- CLIP top 155° hinge
- Opening angle stop 104°
- Mounting plate spacing 6 mm (only for rebated fronts)



Power factor LF = cabinet height KH (mm) x front weight bottom and top incl. handle (kg)

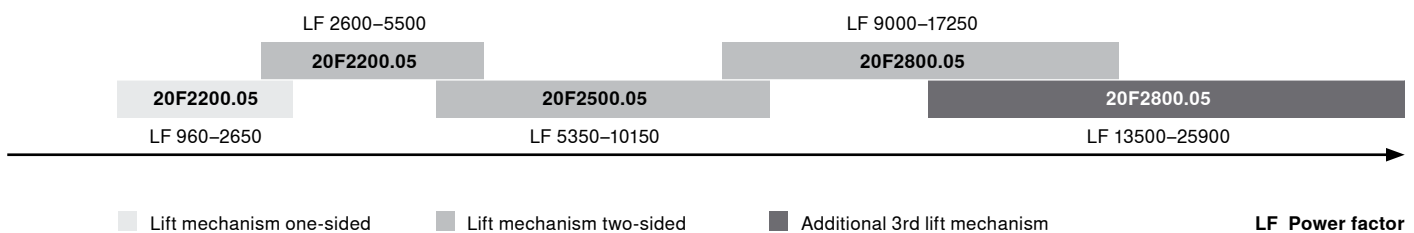

We recommend the more powerful lift mechanism for overlapping areas.

1	Lift mechanism set	
	Power factor LF	
	2600-5500 (1 piece LF 960-2650)	20F2200.05
	5350-10150	20F2500.05
	9000-17250 (3 pieces LF 13500-25900)	20F2800.05
Composed of:		
2 x symmetrical lift mechanisms		
10 x chipboard screws Ø 4 x 35 mm		

2	Telescopic arm set	
	Nickel plated steel	
	Cabinet height 480-570 mm	20F3200.01
	Cabinet height 560-710 mm	20F3500.01
	Cabinet height 700-900 mm	20F3800.01
	Cabinet height 760-1040 mm	20F3900.01
Composed of:		
2 x symmetrical telescopic arms		



Ordering information Symmetrical wooden fronts

3	Cover cap set			
	Plastic			
	light grey, silk white,			
	Consisting of:			20F8000
3a	1 x cover cap large left			
3b	1 x cover cap large right			
3c	2 x round cover caps			

4	Mounting plate for telescopic arm			
	All horizontal mounting plates with 0 mm distance			
	Recommendation:			
	Screws ¹⁾	Spacing 0 mm	2 x	175H3100
	EXPANDO	Spacing 0 mm	2 x	177H3100E
	Knock-in	Spacing 0 mm	2 x	177H3100

5	Mounting plate for CLIP top 155° hinge			
	Mitred application recommendation			
	Screws ¹⁾	Spacing 0 mm	2 x*	175H3100
	EXPANDO	Spacing 0 mm	2 x*	177H3100E
	Knock-in	Spacing 0 mm	2 x*	177H3100
	Rebated application recommendation			
	Screws ²⁾	Spacing 6 mm	2 x*	175H9160

6	CLIP top 155° hinge			
	Boss:	INSERTA	2 x*	70T7540NT1MD
	Steel boss	Unsprung		

* Number of hinges, see front assembly

7	CLIP top centre hinge			
	Boss:	Screws	2 x*	78Z5500T
	Zinc boss	Unsprung		
	Boss:	EXPANDO	2 x*	78Z553ET
	Zinc boss	Unsprung		

8	Mounting plate for CLIP top centre hinge			
	Standard mounting plates with 0 mm distance			
	Recommendation:			
	Screws ¹⁾	Spacing 0 mm	2 x*	175H3100
	EXPANDO	Spacing 0 mm	2 x*	177H3100E
	Knock-in	Spacing 0 mm	2 x*	177H3100

9	Opening angle stop			
	Plastic			
	104° deep grey		2 x	20F7051
	83° Dust grey		2 x	20F7011

i	Information
For SERVO-DRIVE order specification, refer to the Blum catalogue.	
For SERVO-DRIVE planning situation, refer to pages	
	20/21

AVENTOS HF – Mitred and rebated applications

Planning information for symmetrical wooden fronts

Fully surrounded (four sided) mitred applications

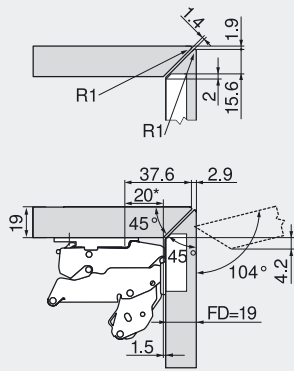

Hinge for dual applications
0 mm mounting plate

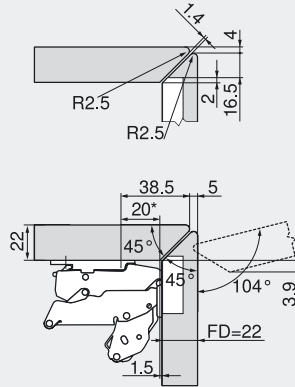

Hinge for dual applications
0 mm mounting plate

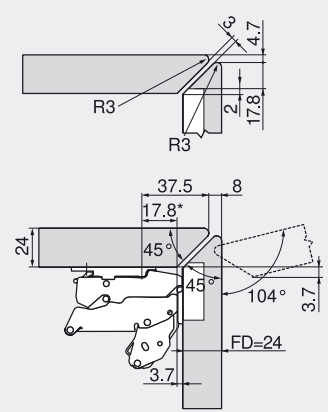

Hinge for dual applications
0 mm mounting plate

Lateral (two sided) mitred applications

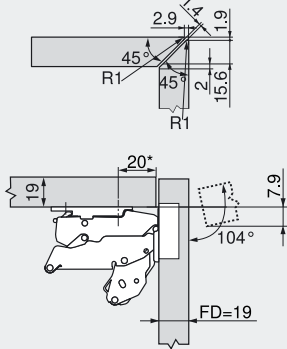

Hinge for dual applications
0 mm mounting plate

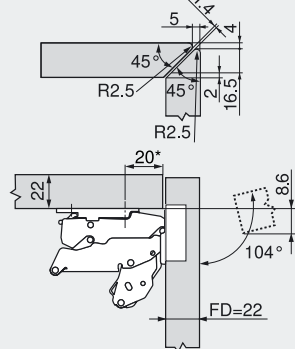

Hinge for dual applications
0 mm mounting plate

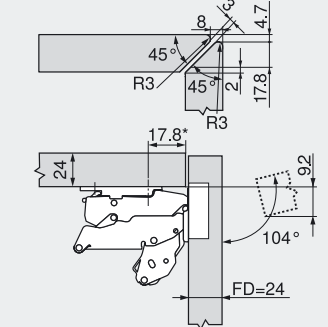

Hinge for dual applications
0 mm mounting plate

Rebated applications

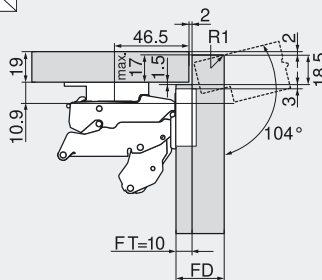

Hinge for dual applications
6 mm mounting plate

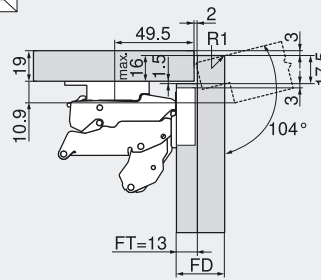

Hinge for dual applications
6 mm mounting plate

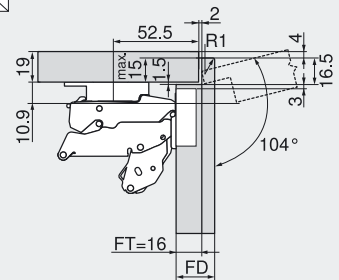

Hinge for dual applications
6 mm mounting plate

FT Rebate depth

FD Front thickness

R Radius

* Dimension for mounting plate with dimension A = 20 mm



Planning information for symmetrical wooden fronts

Drilling position

4 x $\varnothing 4 \times 35$ mm

T Mitred:
 37 mm from IK for FD 19 and 22 mm
 34.8 mm from IK for FD 24 mm

Rebate:
 37 mm + FT from IK

IK Cabinet inner edge
 FT Rebate depth

* Drilling depth 5 mm

Cabinet height	H
480–549 mm	KH x 0.3 -28 mm
550–1040 mm	KH x 0.3 -57 mm

Front assembly

KH Cabinet height

A Mitred:
 12 mm from front inner edge
Rebated:
 11 mm from front inner edge

Number of hinges
 3 hinges starting at cabinet width 1200 mm and/or 12 kg door weight
 4 hinges starting at cabinet width 1800 mm and/or 20 kg door weight

	X
Cabinet height (KH)	177H3100, 177H3100E 177H3100E10, 177H5100 175H3100, 175H4100
480–549 mm	70 mm
550–1040 mm	47 mm

Space requirement

KH Cabinet height

* For rebated application + FT

CLIP top centre hinge

Min. gap F = 1.5 mm

Drilling distance TB

					3	4	5	6
					6	5	4	3
0								
3								
6								
9								

▲ Mounting plate

Space requirement

FH Front height

Opening angle stop

104°	$Y = FH \times 0.24 + 34$ mm
83°	$Y = 0$ mm

Cornice/Crown moulding clearance

Mitred application

FD (mm)	19	22	24						
Z (mm)	40	34	33						

Rebated application

FT (mm)	10		13		16				
FD (mm)	19	22	25	19	22	25	19	22	25
Z (mm)	70	58	45	67	55	42	64	52	39

FD Front thickness
 FT Rebate depth

AVENTOS HS – Mitred and rebated applications

Order specification

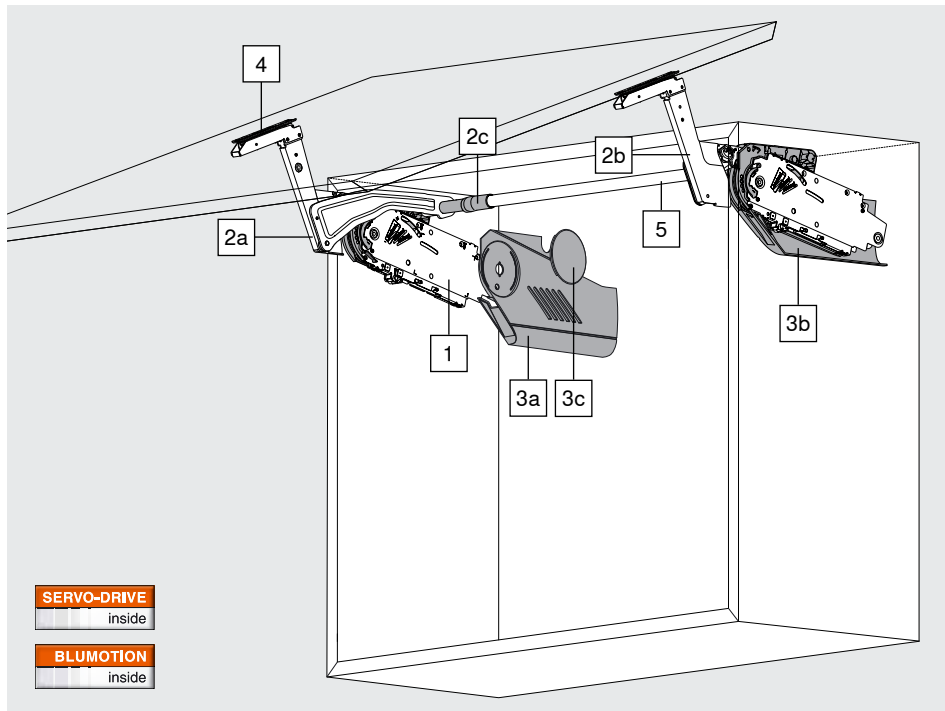

With the AVENTOS HS, even large, one-part fronts appear to defy gravity by swinging up effortlessly. There is enough space for design features such as crown mouldings or cornices.

The cabinet front and door weight is required in order to select the correct lift mechanism.

Example:

KH = 600 mm, weight of front = 10 kg
Selection of lift mechanism = **20S2E00.05**

KH = 602 mm → 600 mm

KH = 603 mm → 605 mm

We recommend the more powerful lift mechanism for overlapping areas.

	1	Lift mechanism set			
		KH 350–525 mm	20S2A00.05	20S2B00.05	20S2C00.05
		KH 526–675 mm	20S2D00.05	20S2E00.05	20S2F00.05
		KH 676–800 mm	20S2G00.05	20S2H00.05	20S2I00.05
Consisting of:					
2 x symmetrical lift mechanisms					
10 x chipboard screws Ø 4 x 35 mm					
	2	Lever arm set			
		Steel, nickel plated			20S3500.06
	Consisting of:				
2a		1 x lever arm left			
2b		1 x lever arm right			
2c		2 x cross stabiliser cover caps			
	3	Cover cap set			
		Plastic			
		light grey, silk white			20S8000
	Consisting of:				
3a		1 x cover cap large left			
3b		1 x cover cap large right			
3c		2 x round cover caps			

	4	Front fixing bracket set		
		Nickel plated		
		Wooden fronts ¹⁾		20S42E1

	5	Cross stabiliser rod round		
		Aluminium, Ø 16 mm		
		For cutting to size, 1061 mm		20Q1061UN
Cutting: LW - 129 mm				

	Connecting piece set for cross stabiliser			
		Aluminium, Ø 16 mm		
		With LW greater than 1190 mm		20Q153ZN
	Cutting for 5: LW / 2 - 147 mm			
Consisting of:				
1 x connecting piece				
1 x fixing				
2 x cross stabiliser cover caps				

LW Inner cabinet width

KH Cabinet height



Order specification

Weight of front incl. handle (kg)

KH (mm)	Weight of front incl. handle (kg)		
	20S2G00.05	20S2H00.05	20S2I00.05
800	4.00-7.00	6.00-12.25	10.50-20.00
795	4.00-7.00	6.00-12.25	10.50-20.00
790	4.00-7.00	6.00-12.25	10.75-20.00
785	4.00-7.00	6.25-12.50	10.75-20.00
780	4.00-7.00	6.25-12.50	10.75-20.25
775	3.75-7.00	6.25-12.50	11.00-20.25
770	3.75-7.00	6.25-12.50	11.00-20.25
765	3.75-7.25	6.50-12.50	11.00-20.25
760	3.75-7.25	6.50-12.75	11.25-20.25
755	3.75-7.25	6.50-12.75	11.25-20.50
750	3.50-7.25	6.50-12.75	11.50-20.50
745	3.50-7.25	6.50-12.75	11.50-20.50
740	3.50-7.25	6.50-12.75	11.75-20.75
735	3.50-7.50	6.50-13.00	11.75-20.75
730	3.50-7.50	6.75-13.00	11.75-21.00
725	3.50-7.50	6.75-13.00	12.00-21.00
720	3.50-7.50	6.75-13.00	12.00-21.25
715	3.50-7.50	6.75-13.00	12.00-21.25
710	3.50-7.75	6.75-13.25	12.25-21.25
705	3.50-7.75	6.75-13.25	12.25-21.50
700	3.50-7.75	6.75-13.25	12.50-21.50
695	3.50-7.75	6.75-13.25	12.50-21.50
690	3.50-7.75	6.75-13.25	12.75-21.50
685	3.50-8.00	7.00-13.25	12.75-21.50
680	3.50-8.00	7.00-13.50	13.00-21.50
676	3.50-8.00	7.00-13.50	13.00-21.50

KH (mm)	Weight of front incl. handle (kg)		
	20S2D00.05	20S2E00.05	20S2F00.05
675	3.00-5.25	5.00-11.00	09.75-19.00
670	3.00-5.25	5.00-11.00	09.75-19.00
665	3.00-5.25	5.00-11.00	09.75-19.00
660	3.00-5.50	5.25-11.25	10.00-19.00
655	3.00-5.50	5.25-11.25	10.00-19.00
650	3.00-5.50	5.25-11.25	10.00-19.00
645	3.00-5.50	5.25-11.25	10.00-18.75
640	3.00-5.50	5.25-11.25	10.00-18.75
635	3.00-5.50	5.25-11.50	10.25-18.75
630	3.00-5.75	5.50-11.50	10.25-18.75
625	3.00-5.75	5.50-11.50	10.25-18.75
620	3.00-5.75	5.50-11.50	10.25-18.75
615	3.00-5.75	5.50-11.50	10.25-18.75
610	3.00-6.00	5.50-11.75	10.50-18.50
605	3.00-6.00	5.50-11.75	10.50-18.50
600	3.00-6.00	5.50-11.75	10.50-18.50
595	3.00-6.00	5.50-11.75	10.50-18.50
590	3.00-6.00	5.50-12.00	10.75-18.25
585	3.00-6.25	5.75-12.00	10.75-18.25
580	3.00-6.25	5.75-12.00	11.00-18.00
575	3.00-6.25	5.75-12.00	11.00-18.00
570	3.00-6.25	5.75-12.25	11.25-17.75
565	3.00-6.25	5.75-12.25	11.25-17.75
560	3.00-6.50	6.00-12.25	11.25-17.50

555	3.00-6.50	6.00-12.50	11.50-17.50
550	3.00-6.50	6.00-12.50	11.50-17.25
545	3.00-6.50	6.00-12.50	11.50-17.25
540	3.00-6.50	6.00-12.75	11.75-17.00
535	3.00-6.75	6.25-12.75	11.75-16.75
530	3.00-6.75	6.25-12.75	11.75-16.75
526	3.00-6.75	6.25-13.00	12.00-16.50

KH (mm)	Weight of front incl. handle (kg)		
	20S2A00.05	20S2B00.05	20S2C00.05
525	2.50-4.00	3.25-7.50	7.25-15.00
520	2.50-4.00	3.50-7.50	7.25-15.00
515	2.50-4.00	3.50-7.50	7.25-14.75
510	2.50-4.00	3.50-7.75	7.50-14.75
505	2.50-4.00	3.50-7.75	7.50-14.75
500	2.50-4.25	3.50-7.75	7.50-14.75
495	2.50-4.25	3.75-7.75	7.50-14.50
490	2.50-4.25	3.75-8.00	7.75-14.50
485	2.50-4.25	3.75-8.00	7.75-14.25
480	2.50-4.25	3.75-8.00	7.75-14.25
475	2.50-4.25	3.75-8.00	7.75-14.00
470	2.50-4.25	4.00-8.25	8.00-14.00
465	2.25-4.25	4.00-8.25	8.00-13.75
460	2.25-4.25	4.00-8.25	8.00-13.75
455	2.25-4.25	4.00-8.50	8.25-13.50
450	2.25-4.25	4.00-8.50	8.25-13.50
445	2.25-4.50	4.25-8.50	8.25-13.25
440	2.25-4.50	4.25-8.50	8.25-13.00
435	2.25-4.50	4.25-8.75	8.50-13.00
430	2.25-4.50	4.25-8.75	8.50-12.75
425	2.25-4.50	4.25-8.75	8.50-12.75
420	2.25-4.50	4.25-8.75	8.50-12.50
415	2.25-4.50	4.25-8.75	8.50-12.50
410	2.25-4.50	4.25-9.00	8.75-12.25
405	2.25-4.50	4.25-9.00	8.75-12.00
400	2.00-4.75	4.25-9.00	8.75-12.00
395	2.00-4.75	4.50-9.00	8.75-11.75
390	2.00-4.75	4.50-9.00	8.75-11.50
385	2.00-4.75	4.50-9.25	9.00-11.50
380	2.00-4.75	4.50-9.25	9.00-11.25
375	2.00-4.75	4.50-9.25	9.00-11.25
370	2.00-4.75	4.50-9.25	9.00-11.00
365	2.00-4.75	4.50-9.25	9.00-11.00
360	2.00-4.75	4.50-9.50	9.25-10.75
355	2.00-4.75	4.50-9.50	9.25-10.50
350	2.00-5.00	4.50-9.50	9.25-10.50



Information

For SERVO-DRIVE order specification, refer to the Blum catalogue.

For SERVO-DRIVE planning situation, refer to pages

20/21



Planning information

Cornice/Crown moulding clearance

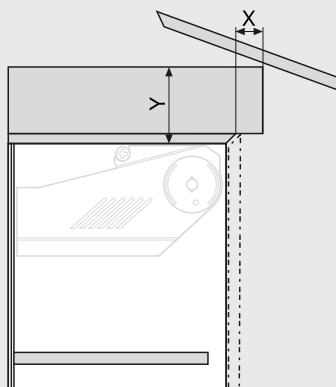

Mitred application

FD	19 mm	22 mm	24 mm
X max	25 mm	23 mm	20 mm
Y max	82 mm	78 mm	76 mm

Rebated application

FT	10 mm	13 mm	16 mm
FD	19–25 mm	19–25 mm	19–25 mm
X max	28 mm	29 mm	28 mm
Y max	85 mm	83 mm	82 mm

Gap = 2 mm

FD Front thickness

FT Rebate depth

Cross stabiliser

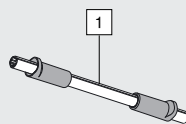

[1] LW - 129 mm

LW Internal cabinet width

Connecting piece

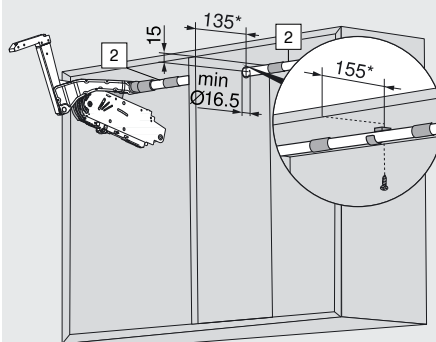

[2] Half LW - 147 mm

LW Internal cabinet width

FT Rebate depth

* For rebated application + FT

AVENTOS HL – Mitred and rebated applications

Order specification

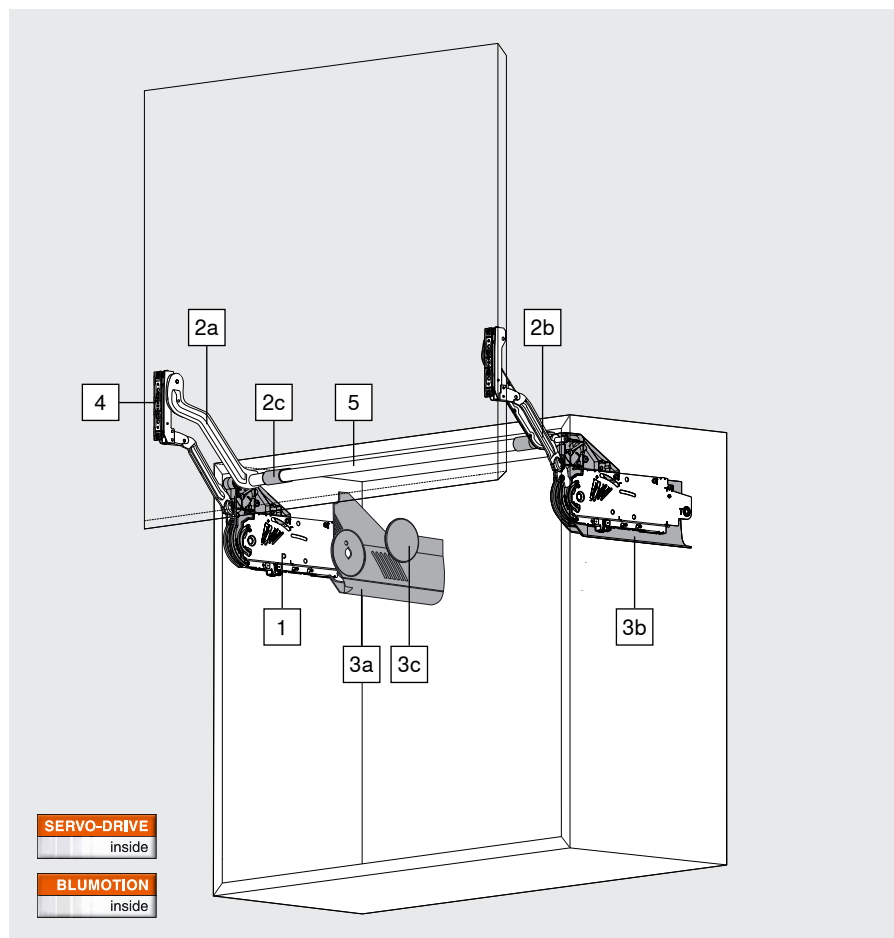

The AVENTOS HL lift up is the ideal solution for small-area, single-piece fronts. As the front moves upwards parallel to the cabinet with this application, special installation situations, such as the installation of electrical equipment in the high cabinet, can be implemented to best effect.

Weight of front incl. handle (kg)	Cabinet height			
	307–356 mm	357–406 mm	407–557 mm	457–587 mm
	Lever arm set			
Lift mechanism set	20L3200.06	20L3500.06	20L3800.06	20L3900.06
20L2100.05	1.25–4.25 kg	1.25–2.50 kg		
20L2300.05	3.50–7.25 kg	1.75–5.00 kg	1.75–3.50 kg	
20L2500.05	6.50–12.00 kg	4.25–9.00 kg	2.75–6.75 kg	2.00–5.25 kg
20L2700.05	11.00–20.00 kg	8.00–14.75 kg	5.75–11.75 kg	4.25–9.25 kg
20L2900.05		13.50–20.00 kg	10.50–20.00 kg	8.25–16.50 kg

We recommend the more powerful lift mechanism for overlapping areas.

1	Lift mechanism set
	20L2100.05
	20L2300.05
	20L2500.05
	20L2700.05
	20L2900.05
Consisting of:	
2 x symmetrical lift mechanisms	
10 x chipboard screws Ø 4 x 35 mm	

2	Lever arm set	
	Cabinet height 307–356 mm	20L3200.06
	Cabinet height 357–406 mm	20L3500.06
	Cabinet height 407–557 mm	20L3800.06
	Cabinet height 457–587 mm	20L3900.06
Composed of:		
2a	1 x lever arm left	
2b	1 x lever arm right	
2c	2 x cross stabiliser cover caps	



Order specification

3	Cover cap set	
	Plastic	
	light grey, silk white,	20L8000.01
	Consisting of:	
3a	1 x cover cap large left	
3b	1 x cover cap large right	
3c	2 x round cover caps	

4	Front fixing bracket set	
	Nickel plated	
	Wooden fronts ¹⁾	20542E1
	Composed of:	
	2 x symmetrical front fixing brackets	
	¹⁾ Use 4 chipboard screws per side for wooden fronts.	

5	Cross stabiliser rod oval	
	Aluminium, Ø 16 mm	
	For cutting to size, 1061 mm	20Q1061UA
	Cutting: LW - 129 mm	
	LW Inner cabinet width	

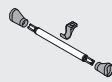
	Connecting piece set for cross stabiliser	
	Aluminium, Ø 16 mm	
	With LW of 1190 mm and up	20Q153ZA
	Cutting for 5: LW / 2 - 147 mm	
	Consisting of:	
	1 x connecting piece	
	1 x fixing	
	2 x cross stabiliser cover caps	
	LW Inner cabinet width	

i	Information
For SERVO-DRIVE order specification, refer to the Blum catalogue.	
For SERVO-DRIVE planning situation, refer to pages	
	20/21

AVENTOS HL – Mitred and rebated applications

Planning information

Mitred application

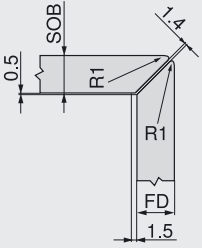

SOB	Top panel thickness
FD	Front thickness
R	Radius

Rebated application

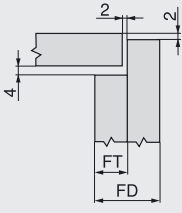

FD	Front thickness
FT	Rebate depth

Drilling position

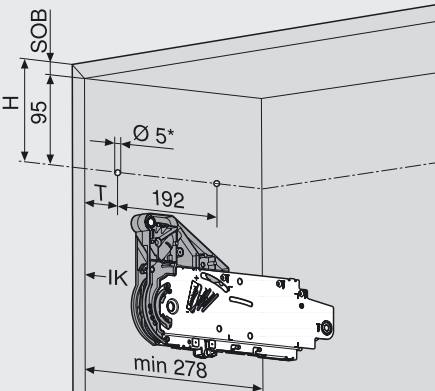

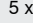
- 5 x  Ø 4 x 35 mm
- T **Mitred:** 37 mm from IK
Rebated: 37 mm + FT from IK
- H 95 mm + SOB
- IK Cabinet inner edge
- SOB Top panel thickness
- * Drilling depth 5 mm

Space requirement

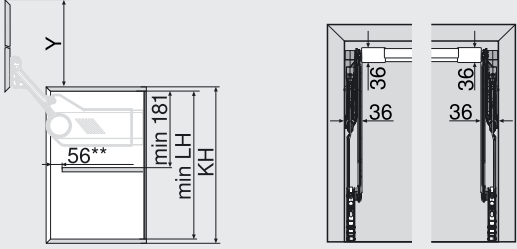

Lever arm set	min LH*	Y*	LH
20L3200.06	262 mm	264 mm	Internal cabinet height
20L3500.06	312 mm	352 mm	Cabinet height
20L3800.06	362 mm	440 mm	Rebate depth
20L3900.06	412 mm	529 mm	

* Dimensions in relation to lower gap = 0 mm
** For rebated application + FT

Front assembly

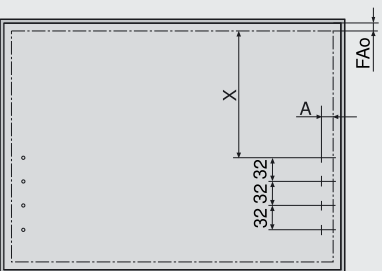

Lever arm set	X (mitred)	X (rebated)
20L3200.06	159.5 mm	156 mm
20L3500.06	209.5 mm	206 mm
20L3800.06	259.5 mm	256 mm
20L3900.06	309.5 mm	306 mm

FAo Upper front overlay
A Space to front inner edge
Mitred: 12 mm, **Rebated:** 8.5 mm
X Space to front inner edge
Wall application: Requires 5 mm minimum gap
Use 4 chipboard screws per side for wooden fronts.

Front setting

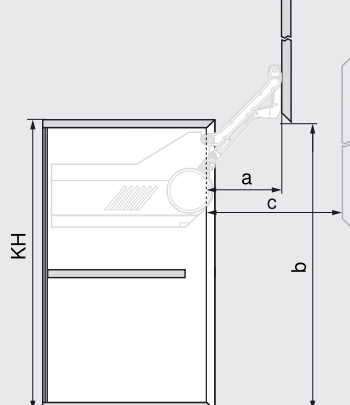

Lever arm set	a**	b*	max. c**
20L3200.06	114 mm	256 mm	159 mm
20L3500.06	146 mm	344 mm	209 mm
20L3800.06	178 mm	432 mm	259 mm
20L3900.06	210 mm	521 mm	309.5 mm

* Dimensions in relation to lower gap = 2 mm
** For rebated application – FT



Planning information

Cornice/Crown moulding clearance

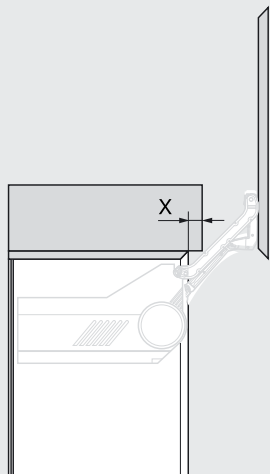

Mitred application

FD	19 mm	22 mm	24 mm
X	18 mm	18 mm	18 mm

Rebated application

FT	10 mm	13 mm	16 mm
FD	19–25 mm	19–25 mm	19–25 mm
X	29 mm	26 mm	23 mm

Gap = 2 mm

FD Front thickness

FT Rebate depth

Cross stabiliser

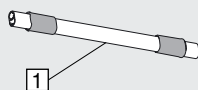

[1] LW - 129 mm

LW Internal cabinet width

Connecting piece

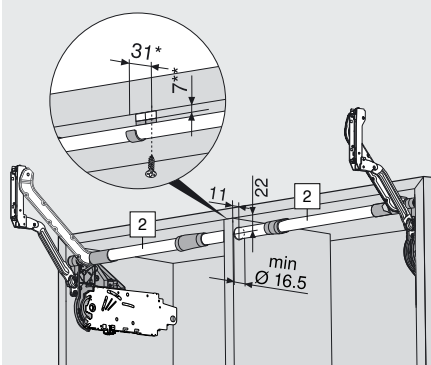

[2] Half LW - 147 mm

LW Internal cabinet width

FT Rebate depth

* For rebated application + FT, in relation to cabinet inner edge

** Add 7 mm spacing

AVENTOS HK – Mitred and rebated applications

Order specification

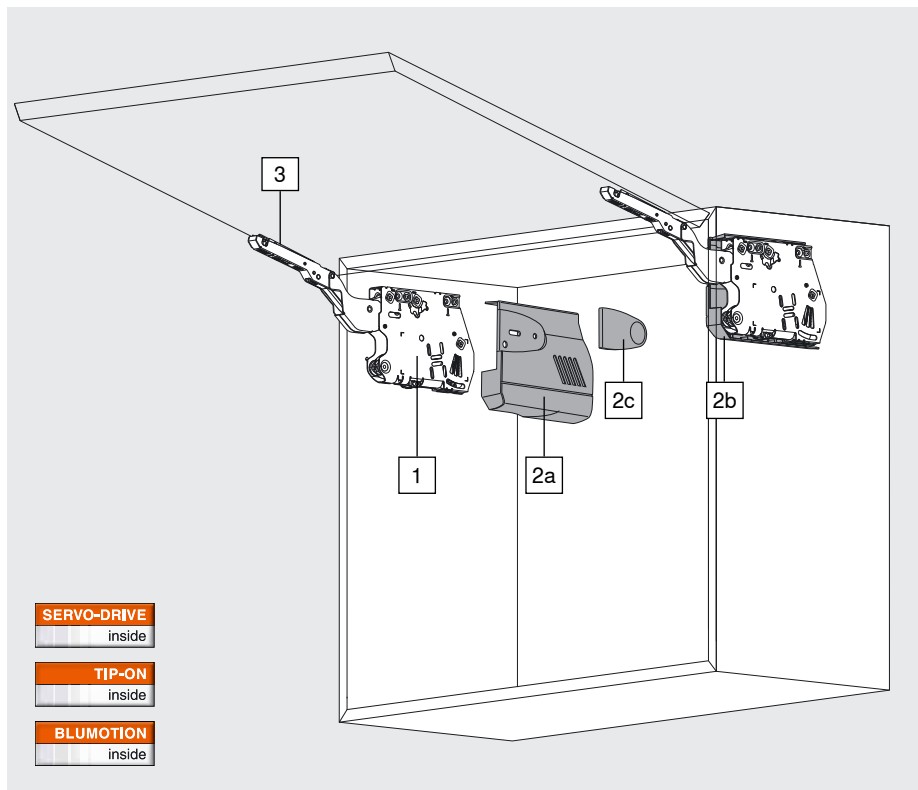

With the AVENTOS HK, the single-piece front needs little space above. This lift system fitting is therefore suitable for lift systems in wall cabinets, in a tall cabinet or above the refrigerator.



Power factor LF = cabinet height KH (mm) x front weight incl. double handle weight (kg)

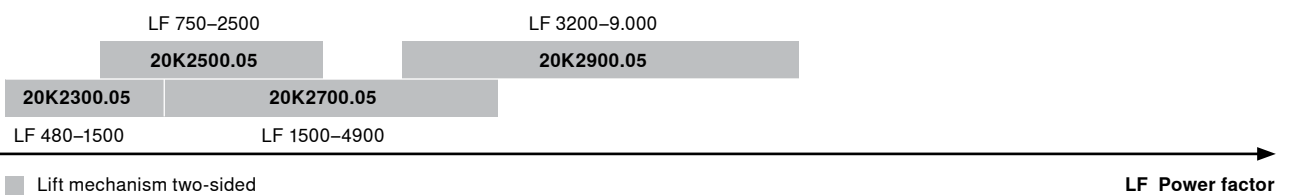

We recommend the more powerful lift mechanism for overlapping areas.

1	Lift mechanism set	
	Power factor	Opening angle
	480–1500	107°
	750–2500	107°
	1500–4900	107°
	3200–9000	100° *)
Consisting of:		
2 x symmetrical lift mechanisms		
6 x chipboard screws Ø 4 x 35 mm		
Max. door weight 18 kg for two lift mechanisms		
*) Pre-mounted opening angle stop		

2	Cover cap set	
	Plastic	
	light grey, silk white,	20K8000
	Composed of:	
2a	1 x cover cap large left	
2b	1 x cover cap large right	
2c	2 x cover caps small	

Note

We recommend a lift mechanism attached to the centre panel for wide cabinets. The reason for this is to prevent the middle of the front from sagging when open.

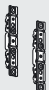

Order specification

	3	Front fixing bracket set	
		Nickel plated	
		Wooden fronts ¹⁾	20542E1
	Consisting of:		
	2 x symmetrical front fixing brackets		
¹⁾ Use 4 chipboard screws per side for wooden fronts.			

	Opening angle stop		
	Plastic		
	100° deep grey	2 x	20K7041
	75° Dust grey	2 x	20K7011

	Information	
	For SERVO-DRIVE and TIP-ON order specification, refer to the Blum catalogue.	
	For SERVO-DRIVE planning situation, refer to pages	20/21
	For TIP-ON planning situation, refer to pages	22/23

AVENTOS HK – Mitred and rebated applications

Planning information

Mitred application

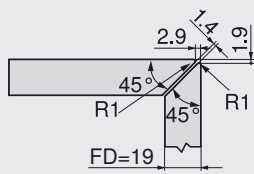

FD Front thickness
R Radius

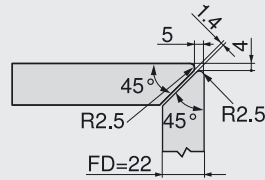

FD Front thickness
R Radius

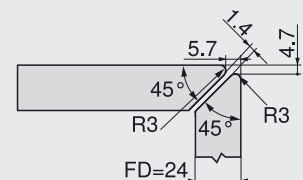

FD Front thickness
R Radius

Rebated application

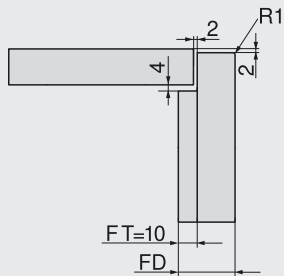

FD Front thickness
FT Rebate depth
R Radius

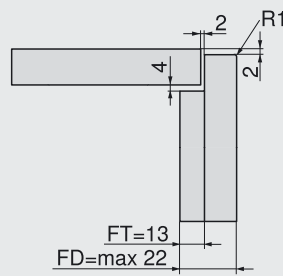

FD Front thickness
FT Rebate depth
R Radius

Drilling position

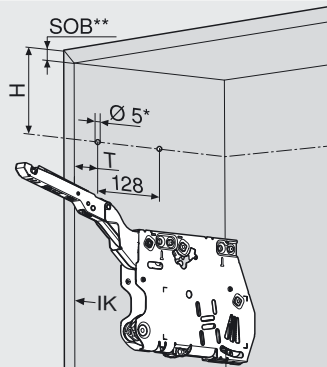

3 x Ø 4 x 35 mm

T **Mitred:** 37 mm from IK
Rebated: 37 mm + FT from IK

H **Mitred:** 90 mm
Rebated: 96 mm

IK Cabinet inner edge

FT Rebate depth

SOB Top panel thickness

* Drilling depth 5 mm

** **Mitred:** max. 24 mm
Rebated: max. 22 mm

Space requirement

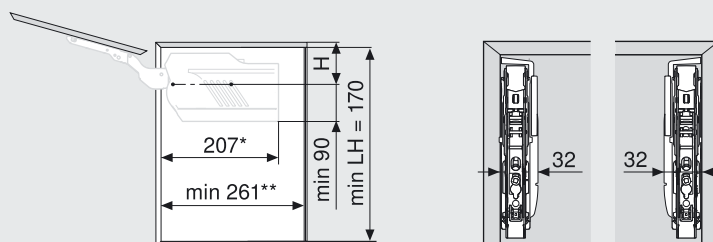

LH Internal cabinet height

H **Mitred:** 90 mm
Rebated: 96 mm

* For rebated application + FT

** At least 261 mm with visible wall hanging bracket
For rebated application + FT



Planning information

Front assembly

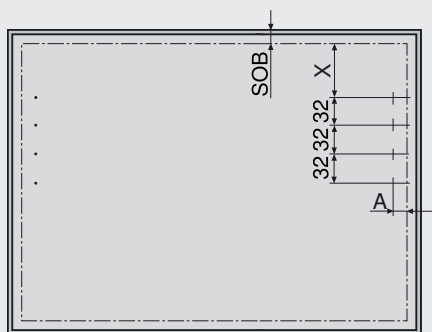

4 x Ø 3.5 x 15 mm

X Space to upper front inner edge
Mitred: 43.5 mm, Rebated: 46 mm

A Space to front inner edge
Mitred: 12 mm, Rebated: 8.5 mm

SOB Top panel thickness

Wall application: Requires 5 mm minimum gap

Use 4 chipboard screws (609.1x00) per side for wooden fronts.

Rebated application minimum gap

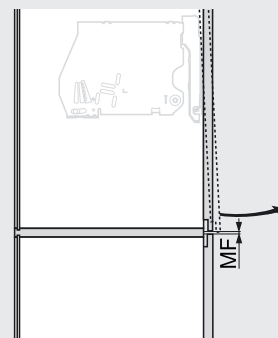

MF Minimum gap for opening (2 mm)

Cornice and crown moulding clearance

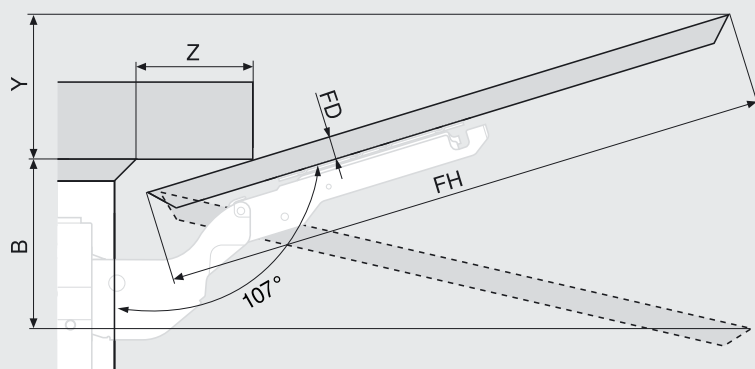

Opening angle stop

	Space requirement
Without	$Y = FH \times 0.29 - 15 + FD$
100°	$Y = FH \times 0.17 - 15 + FD$
75°	$B = FH \times 0.26 + 15 - FD$

FD Front thickness

FT Rebate depth

FH Front height

Mitred application

Front thickness (FD)	19 mm	22 mm	24 mm			
Z 107°	20 mm	-	-			

Rebated application

Rebate depth (FT)		10 mm			13 mm	
Front thickness (FD)	19 mm	22 mm	25 mm	19 mm	22 mm	25 mm
Z 107°	49 mm	39 mm	28 mm	46 mm	36 mm	-

Motion technologies



A light touch on the front with the hand or elbow and the lift systems with SERVO-DRIVE for AVENTOS open as if by itself. To close the lift system, all you have to do is press the easy-to-access switch on the inside of the cabinet. SERVO-DRIVE can be adapted to mitred and rebated applications for AVENTOS HF, AVENTOS HS, AVENTOS HL and AVENTOS HK.

Unlike the standard application, the following are required for mitred applications with SERVO-DRIVE for AVENTOS:

- SERVO-DRIVE items (for order specification, refer to the Blum catalogue)
- Double side panels set back by 1 mm, so that the SERVO-DRIVE switches can be installed.

Unlike the standard application, the following are required for rebated applications with SERVO-DRIVE for AVENTOS:

- SERVO-DRIVE items (for order specification, refer to the Blum catalogue)
- Double side panels set back by the rebate depth plus 1 mm, so that the SERVO-DRIVE switches can be installed.

SERVO-DRIVE for AVENTOS – Mitred and rebated applications

Space requirement

Mitred

DSW Double side panel

Space requirement

Rebated

FT Rebate depth

DSW Double side panel

Front assembly

Mitred and rebated

A	AVENTOS HF	AVENTOS HS/HL/HK
Mitred	12 mm	12 mm
Rebated	11 mm	8.5 mm

A Space to front inner edge

DSW Double side panel

KH Cabinet height

SERVO-DRIVE for AVENTOS – Mitred and rebated applications

Position Blum distance bumper – AVENTOS HF/HS/HL

Mitred and rebated

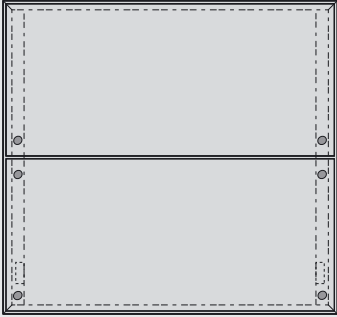

Mitred

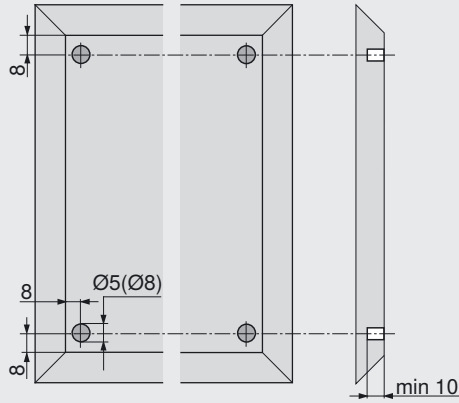

Rebated

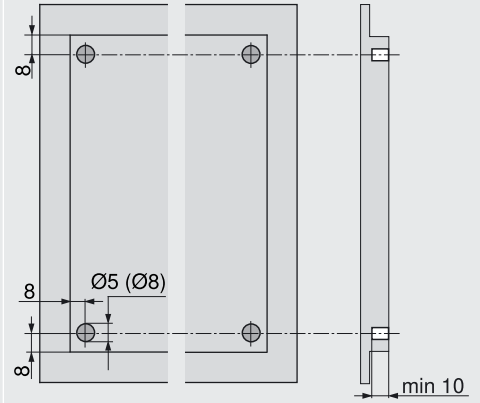

Insert Blum distance bumper (do not glue)

Position Blum distance bumper – AVENTOS HK

Mitred

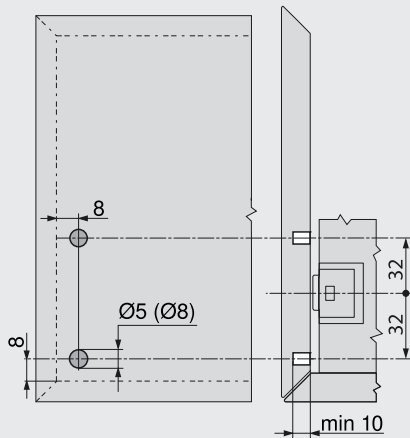

Rebated

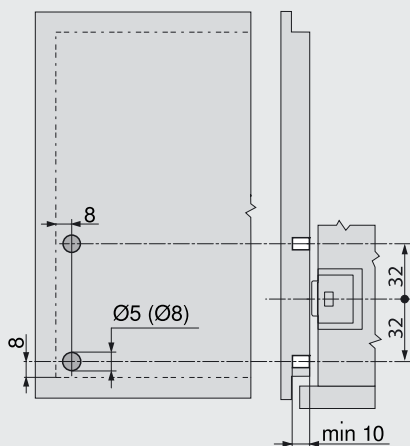

SERVO-DRIVE switch

Mitred

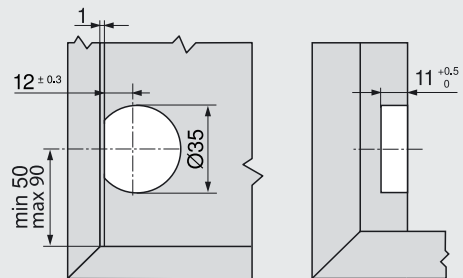

Rebated

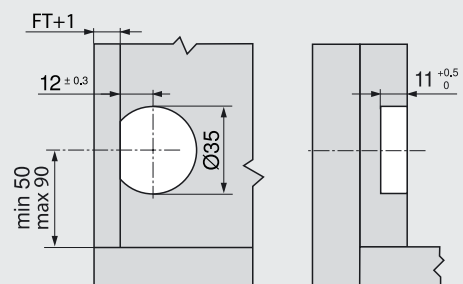

FT Rebate depth

Motion technologies

TIP-ON inside
 TIP-ON for AVENTOS HK, our mechanical opening support system, now makes handle-less fronts easy and convenient to open. To close, press lightly on the front.

Unlike the standard application, the following are required for mitred applications with TIP-ON for AVENTOS:

- TIP-ON items (for order specification, refer to the Blum catalogue)
- With TIP-ON for drilling a double base set back by 1.5 mm

TIP-ON for AVENTOS HK mitred application

For drilling

<p>Front gap</p>	<p>Catch plate</p> <p>* 3 mm off-set assembly</p>
-------------------------	--

Horizontal adapter plate

	<p>Catch plate</p> <p>* 3 mm off-set assembly FAu Lower front overlay</p>
--	---

Unlike the standard application, the following are required for rebated applications with TIP-ON for AVENTOS:

- TIP-ON items (for order specification, refer to the Blum catalogue)
- With TIP-ON for drilling a double base set back by 1 mm in addition to the rebate depth

TIP-ON for AVENTOS HK rebated application

For drilling		
	<p>Front gap</p>	<p>Catch plate</p>
FT Rebate depth		* 3 mm off-set assembly
Horizontal adapter plate		
		<p>Catch plate</p>
FT Rebate depth	FT Rebate depth	* 3 mm off-set assembly FAu Lower front overlay

Blum Showrooms

Sydney (Head Office)
10 Blackbird Close
Len Waters Estate NSW 2171
Ph: 02 9612 5400

Brisbane:
6/39-45 Compton Rd
Underwood QLD 4119
Ph: 07 3135 9490

Melbourne:
4/245 Ferntree Gully Rd
Mount Waverly VIC 3149
Ph: 03 9982 1720

Perth:
3/50 Howe St
Osborne Park WA 6916
Ph: 08 6467 0110

Adelaide:
179 Railway Terrace
Mile End SA 5031
Ph: 08 8118 6070

All content is copyrighted by Blum.
Subject to technical modifications and changes to the range without notice.
Printed in Austria · IDNR: 1.001.46



ISO 9001
Certified Quality
System



ISO 14001
Certified Environmental
System



ISO 50001
Certified Energy
System

The Blum logo, consisting of a stylized arrow pointing up and to the right, followed by the word 'blum' in a bold, lowercase, sans-serif font, with a registered trademark symbol (®) to the upper right.