



WASTEBIN 450 Lt.60

REV. 00.2017

Prodotto ed assemblato in Italia / Made and assembled in Italy

CARATTERISTICHE • FEATURES

Pattumiera ad estrazione totale da 450 mm Lt. 60
Full extension wastebin 450 mm Lt. 60

MINUTERIA INTERNA • FITTINGS

n°12 3,9x13 Vite autofilettante TC a croce / Self tapping screws TC
n°8 4x16 Vite autofilettante TSP a croce / Self tapping screws TSP
n°4 M4x5 Vite cilindrica / Cylinder screw

COMPONENTI • PARTS

- A. n°1** Box metallico / Metal box
- B. n°1** Coperchio / Lid
- C. n°1** Kit guide Blum / Kit Blumslides
- D. n°1** Coppia carter guide / Kit slide carter
- E. n°2** Lamiera reggi coperchio / Metal plate
- G. n°1** Secchio grande 60 Lt. / Big bin Lt.60
- H. n°1** Coppia attacco antenna / Kit door fixing brackets
- I. n°2** Squadretti stabilizzatori antenna / Door stabilising elements

UTENSILERIA • TOOLS

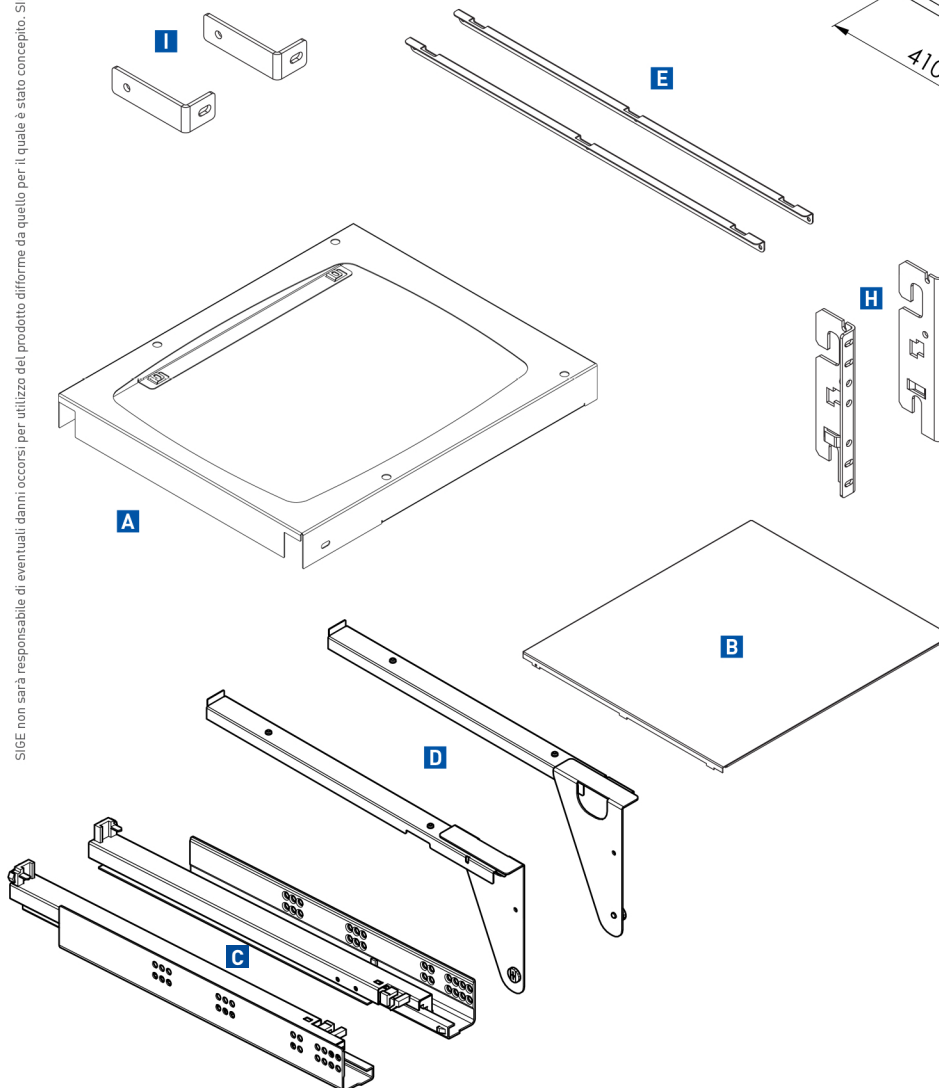
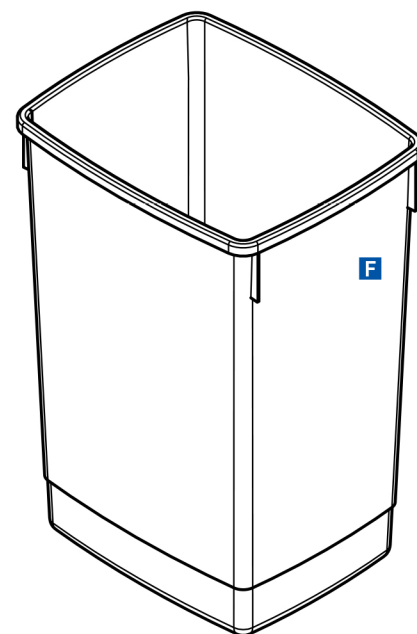
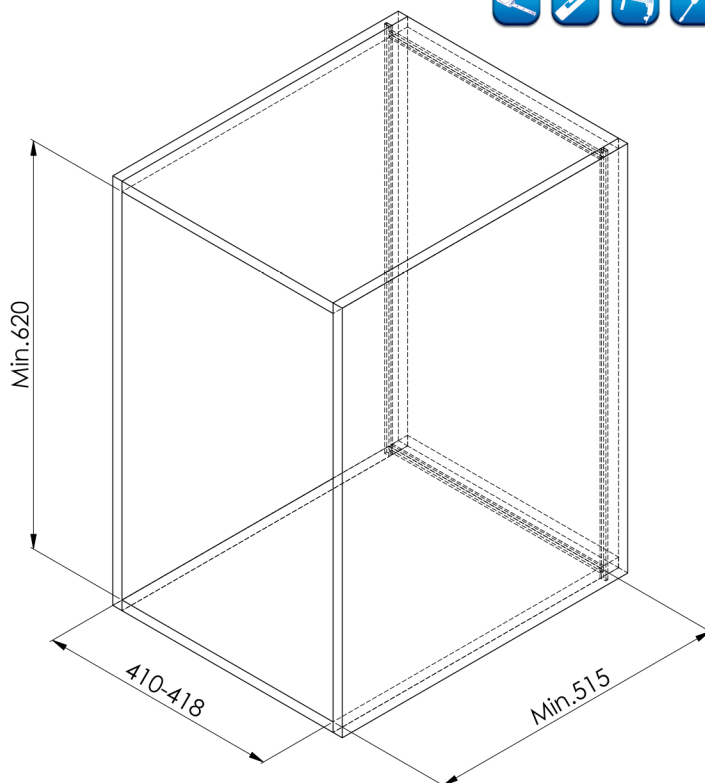

SIGE non sarà responsabile di eventuali danni occorsi per utilizzo del prodotto difforme da quello per il quale è stato concepito. SIGE will not be responsible for any eventual damage due to a different use from the one it has been made.



1

Fissare le guide C e le lamiere reggi coperchio E rispettando le quote.

Fix the slides C and the metal lid holder plate following the given dimensions.

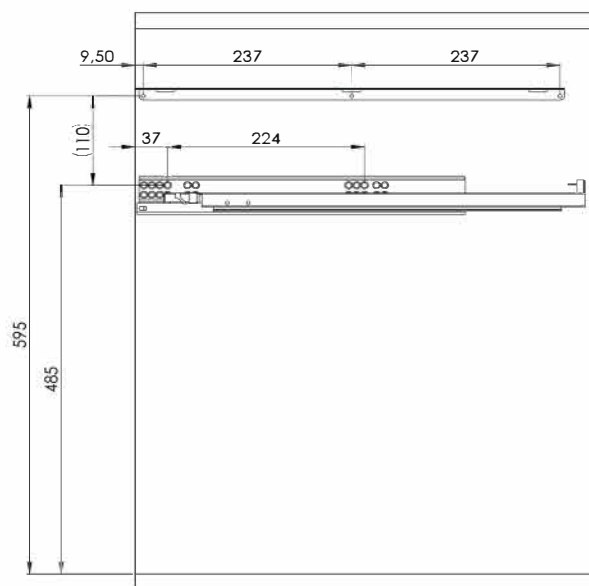
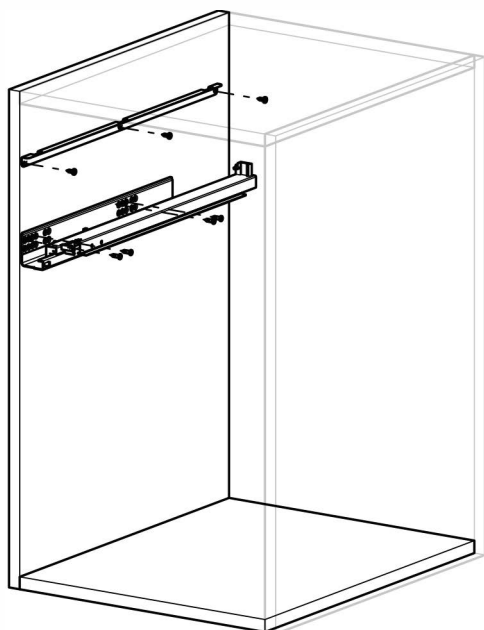

Inserire la coppia carter guide D nelle guide C.

Put the kit slide carter D into the slides C.

2

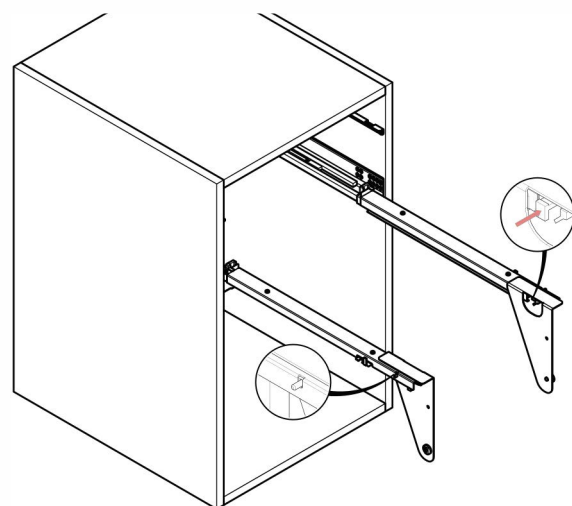
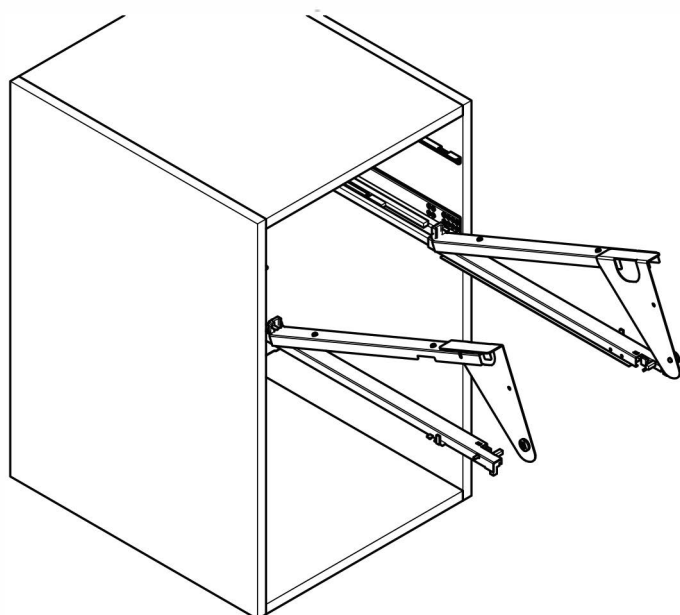

3

Avvitare il box metallico A nei carter guide D mediante le apposite viti.

Screw the metal box A into the kit slide carter D by using the specific provided screws.

N°4 M4x5

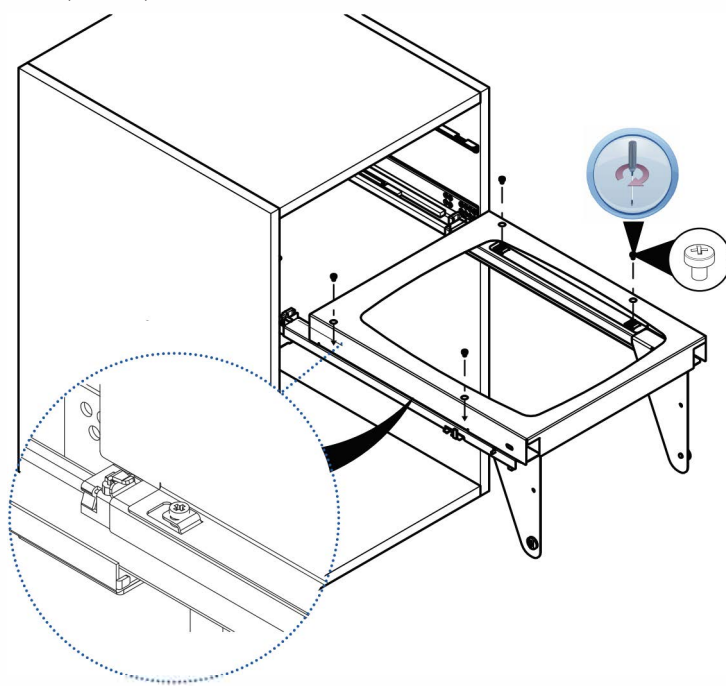
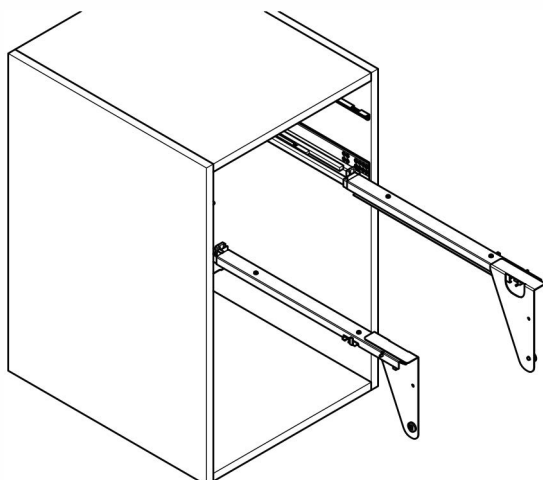



4

Fissare la coppia attacco antina H nell'anta, rispettando le quote.

Assemble the kit door fixing brackets H along with the door respecting the quotes.

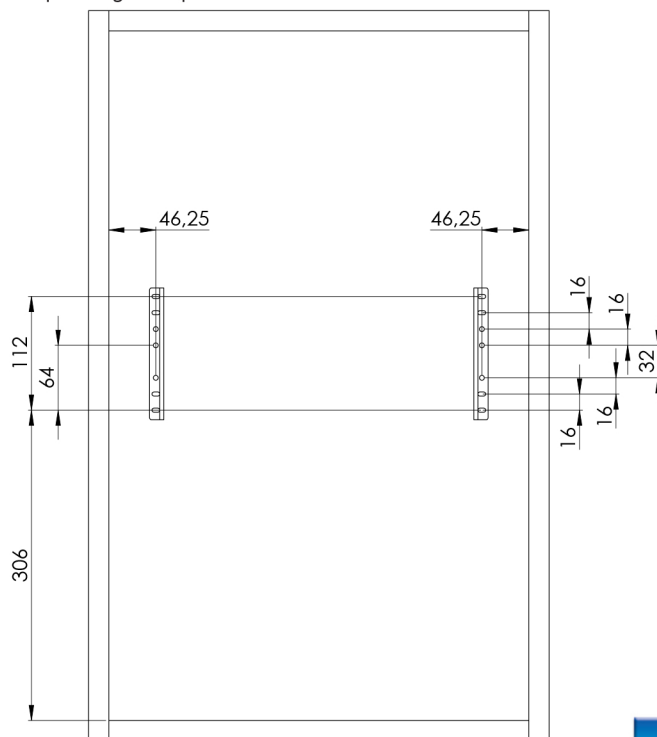
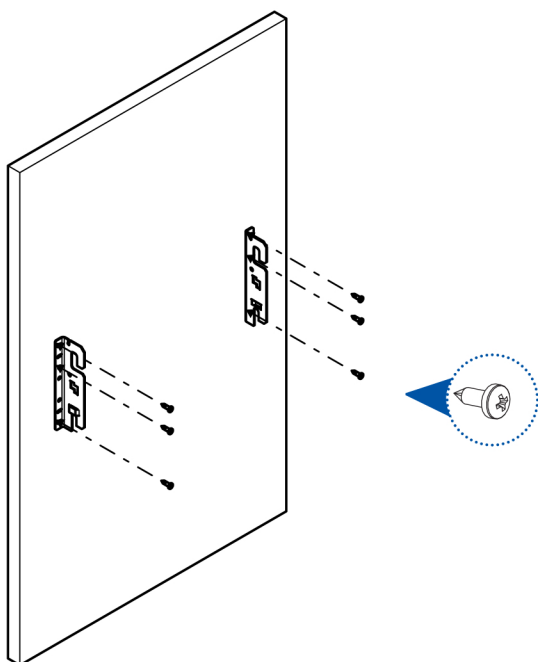

5

Inserire l'antina nei carter D e serrare il tutto a mezzo vite e rondella speciali.

Put the door into the carter D and fix them by using the specific screw and washer.

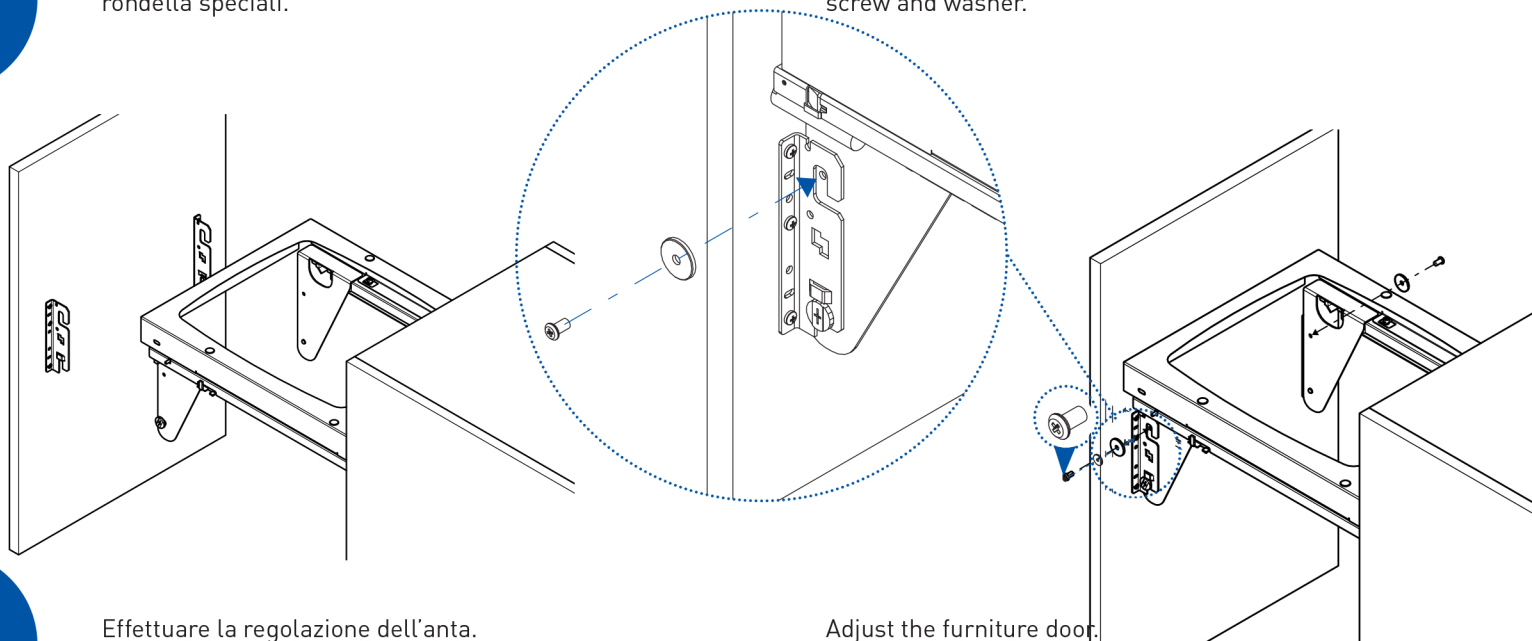

6

Effettuare la regolazione dell'anta.

Adjust the furniture door.

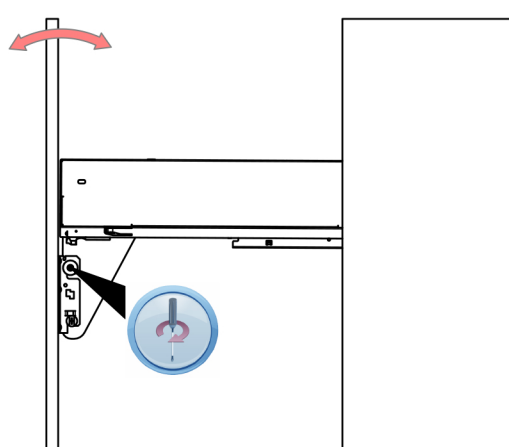
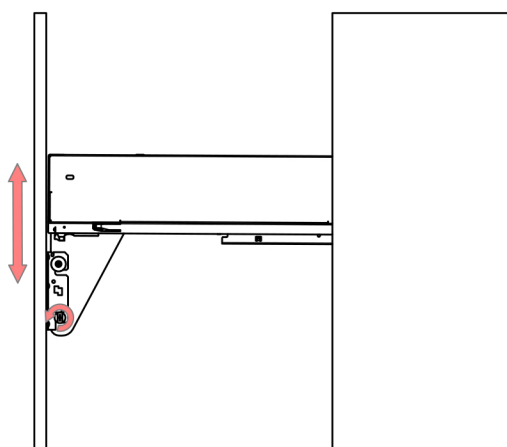



7

Fissare i squadretti stabilizzatori anta I come illustrato dalle foto.

Fix the door stabilising elements I as shown in the pictures.

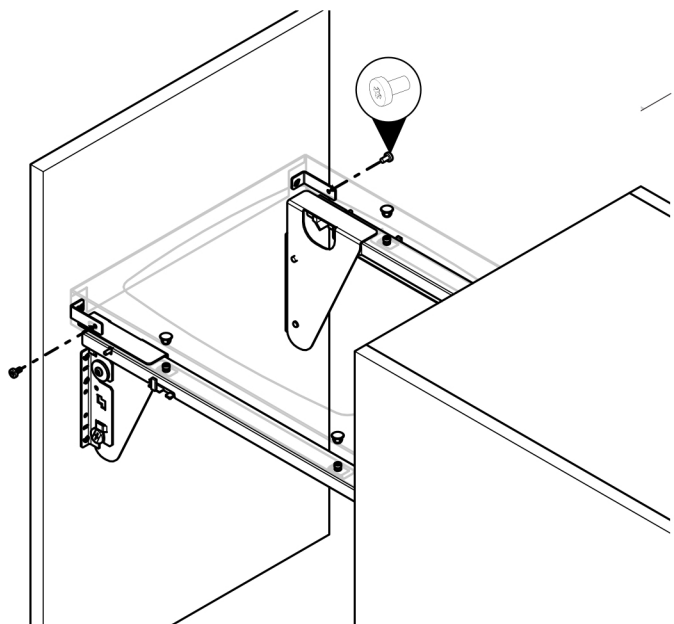
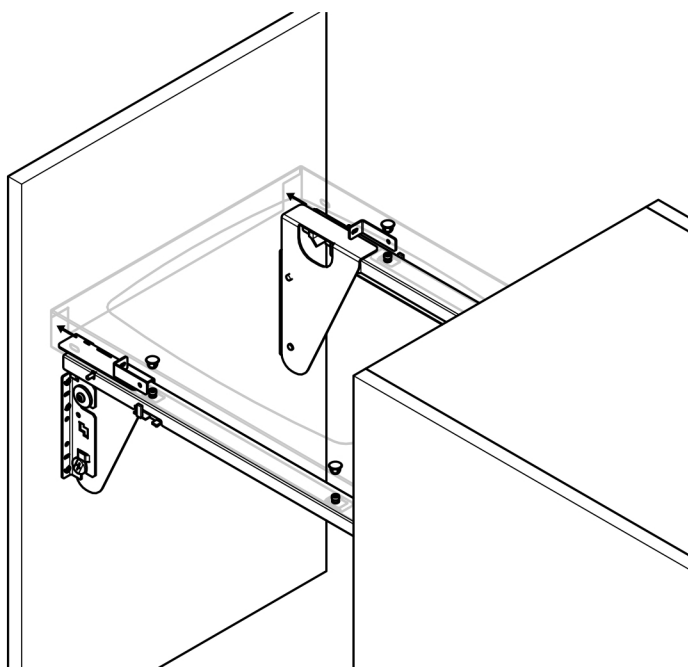

8

Inserire il coperchio B nelle lamiera reggi coperchio E ed inserire le pattumiere F e G.

Put the lid B into the metal lid holder plate E and insert both the small and big bins (F and G) too.

